

# Nylon Standard Plug NSD



Nylon Standard Plug NSD

## Description

The nylon standard plug NSD with 2-way expansion is suitable for quick fixings with low loads in concrete and solid masonry. As the hammer-in stop prevents premature spreading, the nylon standard plug NSD is particularly suitable for through fastening, even with pre-assembled screw. The high reliability of assembly is due to large rotation locks that prevent turning in the hole.

## Applications

Surface mount boxes, images, letter boxes, curtain rails, towel racks, lamps, baseboards, motion detectors, smoke and fire alarms as well as light panels, plates, hanging cabinets and wall shelves and much more.

## Material:

- High-quality polyamide (nylon)
- Halogen-free and silicone-free
- Temperature resistant from -40°C to +80°C

**Range of loading: 0,03 kN – 1,9 kN**



## Nylon Standard NSD



- Suitable for pre-installation and through fastening
- Hold due to high material strength and manufacturing quality

Description	Ref. No.	Ø [mm]	Length [mm]	Woodscrew -Ø [mm]	Chipboard screw-Ø [mm]	Package content [pcs.]	Weight per pck. kg	Packages per master box
NSD 5	65125001	5	25	2,5 - 4	4	100	0,046	4.800
NSD 6	65225001	6	30	3,5 - 5	5	100	0,070	4.800
NSD 8	65425001	8	40	4,5 - 6	6	100	0,145	2.400
NSD 10	65525001	10	50	6 - 8	-	50	0,135	1.200
NSD 12	65625001	12	60	8 - 10	-	25	0,110	600
NSD 14	65725001	14	75	10 - 12	-	20	0,160	480
NSD 16	65825001	16	80	12 - 14	-	10	0,111	240
NSD 20	65925001	20	90	16	-	5	0,200	120

## Loads and performance data

Recommended loads, any direction			NSD 5	NSD 6	NSD 8	NSD 10	NSD 12	NSD 14
<b>With Woodscrew-ø</b>	<b>dS</b>	<b>[mm]</b>	<b>4</b>	<b>5</b>	<b>6</b>	<b>8</b>	<b>10</b>	<b>12</b>
Concrete B25; C20/25	rec. F	[kN]	0,25	0,38	0,6	0,9	1,4	1,9
Solid brick Mz12	rec. F	[kN]	0,25	0,3	0,5	-	-	-
Solid sand-slim KS12	rec. F	[kN]	0,25	0,3	0,5	-	-	-
Aerated concrete PP4, PB4	rec. F	[kN]	0,03	0,06	0,1	0,15	0,2	-
<b>Spacing and edge distance</b>								
Setting depth	hs	[mm]	25	30	40	50	60	75
Spacing	a	[mm]	50	60	80	100	120	140
Edge distance	ar	[mm]	25	30	40	50	60	70
<b>Installation parameters</b>								
Drill hole diameter	d <sub>o</sub>	[mm]	5	6	8	10	12	14
Depth of drill hole	h <sub>o</sub>	[mm]	35	40	50	65	75	85
Minimum length of screw	l <sub>s</sub>	[mm]	fixture thickness + anchor length + 1 x screw diameter					

## Installation

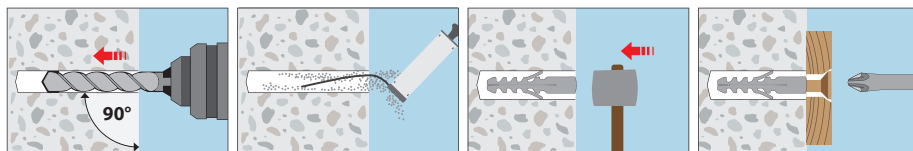

**User tip**  
Since the plug spreads in two directions only, turn the plug, when using close to the edge, so that the spreading force acts parallel to the edge.